

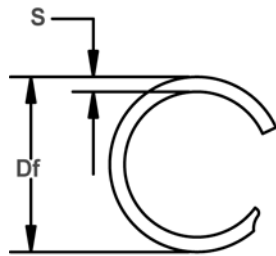

KLR 穴用スパイラルリング

単巻型穴用 重荷重用
重荷重に対応する
単巻スパイラルリング。



自由径 & 止め輪寸法

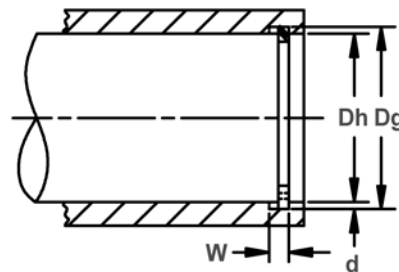
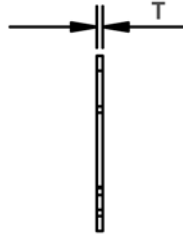

穴径 & 溝寸法

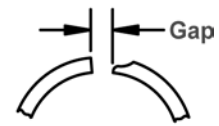

先端部デザイン
オプション

止め輪 番号	穴径 (In.)	溝寸法				止め輪寸法						荷重 (lbs.)	
		溝径		溝巾		自由径		板厚		板幅		止め輪 安全率 (=3)	溝 安全率 (=2)
		Dh	Dg	公差	W	公差	Di	公差	T	公差	S	公差	
KLR-50	.500	.524		.043		.529		.037		.055		2325	424
KLR-56	.562	.586	+ .004	.043		.591		.037		.055		2613	477
KLR-62	.625	.657	- .000	.043		.665	+ .013	.037		.065		2906	707
KLR-68	.687	.719		.043		.726	- .000	.037		.065		3194	777
KLR-75	.750	.790	+ .005	.043		.797		.037		.075		3487	1060
KLR-81	.812	.852	- .000	.043		.860		.037		.075		3775	1148
KLR-87	.875	.915		.043		.924		.037		.075		4068	1237
KLR-93	.937	.985		.051		1.000		.045		.085		5334	1590
KLR-100	1.000	1.048	+ .008	.051		1.058		.045		.085		5693	1696
KLR-106	1.062	1.110	- .000	.051		1.121		.045		.094		6045	1802
KLR-112	1.125	1.181		.051		1.192		.045	± .002	.094	± .004	6404	2227
KLR-118	1.187	1.243		.051		1.252	+ .015	.045		.094		6757	2349
KLR-125	1.250	1.316		.051		1.336	- .000	.045		.094		7116	2916
KLR-131	1.312	1.378		.051		1.391		.045		.094		7469	3060
KLR-137	1.375	1.453		.063		1.470		.057		.128		9307	3791
KLR-143	1.437	1.515	+ .010	.063		1.529		.057		.128		9727	3961
KLR-150	1.500	1.578	- .000	.063		1.592		.057		.128		10153	4135
KLR-156	1.562	1.666		.073		1.687		.067		.158		12400	5741
KLR-162	1.625	1.729		.073	+ .006	1.746		.067		.158		12901	5973
KLR-168	1.687	1.791	- .000	.073	- .000	1.808	+ .020	.067		.158		13393	6201
KLR-175	1.750	1.862		.073		1.885	- .000	.067		.158		13893	6927
KLR-181	1.812	1.924		.073		1.942		.067		.158		14385	7173
KLR-187	1.875	1.987		.073		2.007		.067		.158		14885	7422
KLR-193	1.937	2.055		.085		2.074		.076		.200		16649	8078
KLR-200	2.000	2.118		.085		2.143		.076		.200		17191	8341
KLR-206	2.062	2.180		.085		2.200		.076		.200		17724	8599
KLR-212	2.125	2.243		.085		2.264		.076		.200		18265	8862
KLR-218	2.187	2.305		.085		2.327	+ .025	.076		.200		18798	9121
KLR-225	2.250	2.368		.085		2.389	- .000	.076		.200		19340	9384
KLR-231	2.312	2.430	+ .012	.085		2.453		.076		.200		19873	9642
KLR-237	2.375	2.493	- .000	.085		2.517		.076		.200		20414	9905
KLR-243	2.437	2.555		.085		2.582		.076		.200		20947	10163
KLR-250	2.500	2.618		.085		2.643		.076		.200		21488	10426
KLR-256	2.562	2.680		.104		2.705		.095		.200		26225	10685
KLR-262	2.625	2.743		.104		2.777		.095	± .003	.200	± .005	26870	10947
KLR-268	2.687	2.805		.104		2.828		.095		.200		27504	11206
KLR-275	2.750	2.868		.104		2.899		.095		.200		28149	11469
KLR-281	2.812	2.930		.104		2.958	+ .030	.095		.200		28784	11727
KLR-287	2.875	2.993	- .000	.104		3.022	- .000	.095		.200		29429	11990
KLR-293	2.937	3.055		.104		3.084		.095		.200		30063	12249
KLR-300	3.000	3.118		.104		3.145		.095		.200		30708	12511
KLR-306	3.062	3.184		.104		3.218		.095		.200		31343	13203
KLR-312	3.125	3.263	+ .013	.104		3.294		.095		.237		31988	15242
KLR-318	3.187	3.325	- .000	.104		3.357		.095		.237		32622	15544
KLR-325	3.250	3.388		.104		3.420		.095		.237		33267	15851

単位: inch



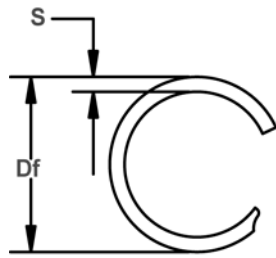

自由径 & 止め輪寸法

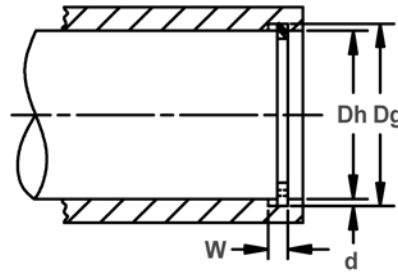
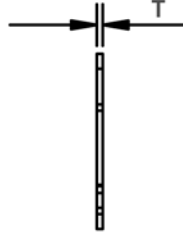

穴径 & 溝寸法

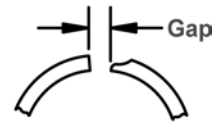

先端部デザイン
オプション

止め輪 番号	穴径 (In.)	溝寸法				止め輪寸法				荷重 (lbs.)			
		溝径		溝巾		自由径		板厚		板幅		止め輪 安全率 (=3)	溝 安全率 (=2)
		Dh	Dg	公差	W	公差	Df	公差	T	公差	S		
KLR-331	3.312	3.450		.124		3.483		.115		.248		38952	16154
KLR-337	3.375	3.513		.124		3.547		.115		.248		39693	16461
KLR-343	3.437	3.575		.124		3.609		.115		.248		40422	16763
KLR-350	3.500	3.638		.124		3.673		.115		.248		41163	17071
KLR-356	3.562	3.700	+.013 -.000	.124		3.728	+.035 -.000	.115	±.003	.248		41892	17373
KLR-362	3.625	3.763		.124		3.799		.115		.248			
KLR-368	3.687	3.825		.124		3.862		.115		.248		43362	17983
KLR-375	3.750	3.888		.124		3.922		.115		.248		44103	18290
KLR-381	3.812	3.950		.124		3.988		.115		.248		44832	18592
KLR-387	3.875	4.013		.124		4.044		.115		.248		45573	18900
KLR-393	3.937	4.075		.124		4.114		.115		.248		46302	19202
KLR-400	4.000	4.158	+.021 -.000	.163		4.223	+.050 -.000	.153	±.004	.265	±.005	60283	22337
KLR-412	4.125	4.283		.163		4.329		.153		.265			
KLR-425	4.250	4.408		.163		4.452		.153		.265		64050	23733
KLR-437	4.375	4.533		.163		4.576		.153		.265		65934	24431
KLR-450	4.500	4.658		.163		4.703		.153		.265		67818	25129
KLR-462	4.625	4.783	+.024 -.000	.163	+.007 -.000	4.829	+.055 -.000	.153	±.005	.265	±.006	69702	25827
KLR-475	4.750	4.908		.163				4.945		.153		.265	
KLR-487	4.875	5.033		.163		5.082		.153		.265		73469	27223
KLR-500	5.000	5.158		.163		5.207		.153		.265		75353	27921
KLR-525	5.250	5.408	+.028 -.000	.163	+.007 -.000	5.460	+.070 -.000	.153	±.005	.265	±.007	79121	29317
KLR-550	5.500	5.658		.163				5.719		.153		.265	
KLR-575	5.750	5.908		.163		5.965		.153		.265		86656	32109
KLR-600	6.000	6.196		.163		6.256		.153		.316		90424	41563
KLR-625	6.250	6.446		.163		6.508		.153		.316		94191	43295
KLR-650	6.500	6.696		.163		6.760		.153		.316		97959	45027
KLR-675	6.750	6.946		.163		7.013		.153		.316		101727	46759
KLR-700	7.000	7.196		.163		7.266		.153		.316		105494	48490
KLR-725	7.250	7.446		.163		7.541		.153		.316		109262	50222
KLR-750	7.500	7.696		.163		7.762		.153		.316		113030	51954
KLR-775	7.750	7.946	+.031 -.000	.163	+.007 -.000	8.023	+.070 -.000	.153	±.005	.316	±.006	116797	53686
KLR-800	8.000	8.196		.163				8.276		.153		.316	
KLR-825	8.250	8.486		.203		8.580		.192		.373		147399	68813
KLR-850	8.500	8.736		.203		8.821		.192		.373		151866	70898
KLR-875	8.750	8.986		.203		9.073		.192		.373		156332	72983
KLR-900	9.000	9.236		.203		9.326		.192		.373		160799	75068
KLR-925	9.250	9.486		.203		9.580		.192		.373		165265	77154
KLR-950	9.500	9.736		.203		9.831		.192		.373		169732	79239
KLR-975	9.750	9.986		.203		10.083		.192		.373		174199	81324
KLR-1000	10.000	10.314	+.031 -.000	.203	+.007 -.000	10.414	+.120-0.000	.192	±.005	.435	±.007	178665	110977
KLR-1025	10.250	10.564		.203				10.660		.192		.435	
KLR-1050	10.500	10.814		.203		10.919		.192		.435		187599	116526
KLR-1075	10.750	11.064		.203		11.171		.192		.435		192065	119300
KLR-1100	11.000	11.314		.203		11.440		.192		.435		196532	122074

単位: inch

